

INSTALLATION INSTRUCTIONS	Accessory Tachometer Installation Kit	Application 1989 FL400	Publications No. MII4494 8810
			Issue Date October 1988

This Tachometer Installation Kit provides the wiring necessary to install the Tachometer (P/N 08172-VM000) and its Bracket (P/N 08172-VM020). The Tachometer and Bracket are not included and must be purchased separately.

1 PARTS LIST

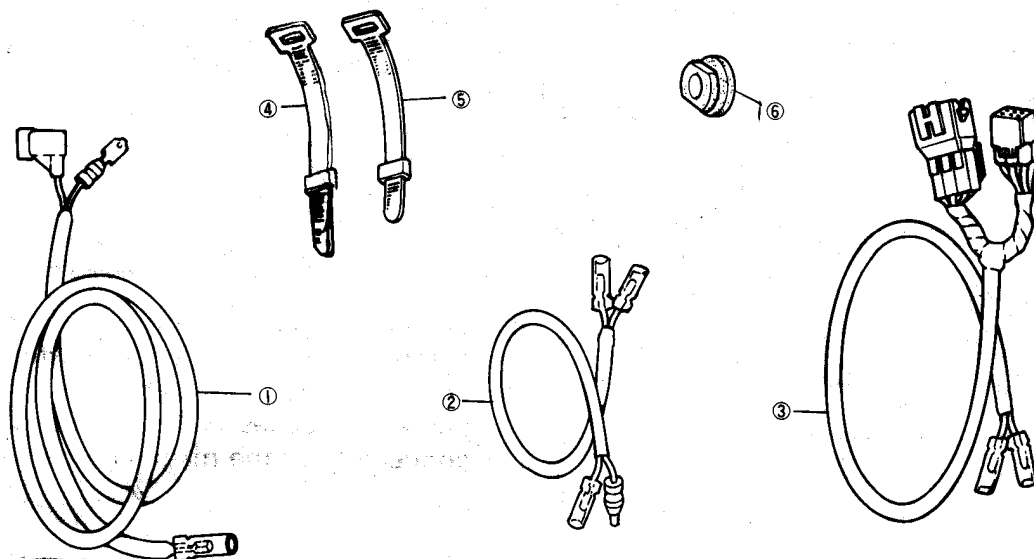

Index No.	Description	Q'ty	Part Number
①	Pulser harness	1	08172-HE000-01
②	Ground harness	1	08172-HE000-02
③	Power harness	1	08172-HE000-03
④	Wire band, short	8	32161-438-000
⑤	Wire band, long	2	32161-VM0-770
⑥	Grommet	1	08175-HA800-11

2 TOOLS REQUIRED

- Drill-20mm (13/16 in)
- 8mm box wrench
- 10mm box wrench

3 INSTALLATION

1. Remove the pad band cut and remove a 120mm from the center part of the cross bar pad as shown.

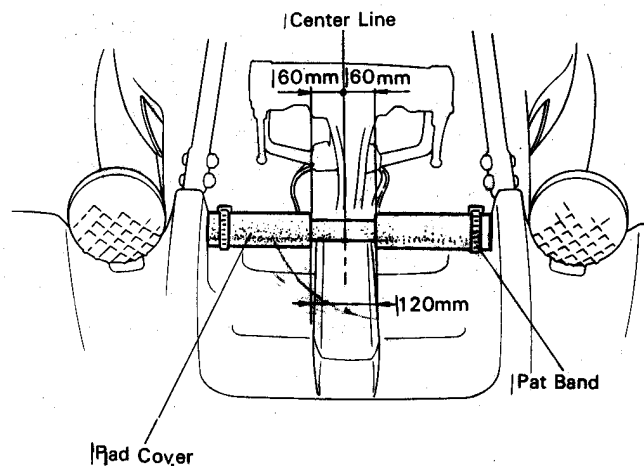

2. Remove the two 6×16 flange bolts attaching the tachometer jaws together. Spread the jaws apart so the clamp will slip over the cross bar.
3. Wrap the rubber cushion around the cross bar and install the bracket over the cushion using the two bolts just removed. Do not tighten the bolts yet.

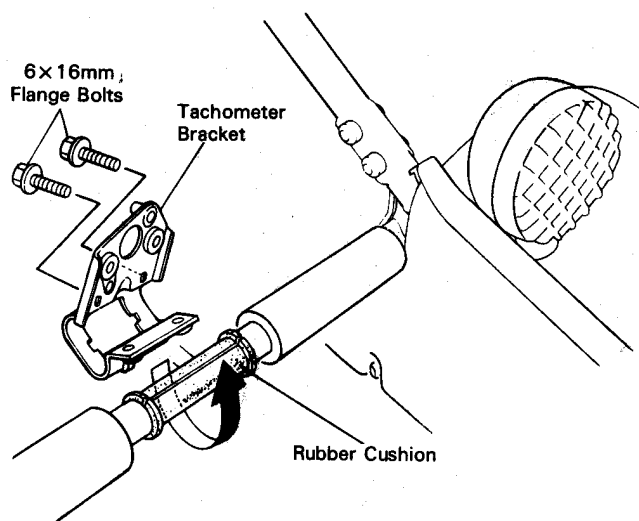

4. Attach the tachometer to the bracket using the two 6mm cap nuts. Torque the nuts.
Torque : 1.2 kg-m, 12 N.m (9 lb-ft).

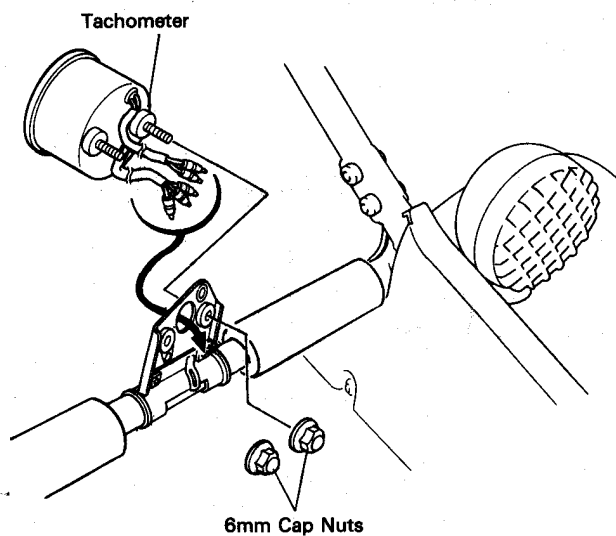

5. Remove the steering column cover. Drill a 20mm, (13/16 in) hole in the cover, 25mm from the right side edge of the cover and 50mm from the top edge of the cover.

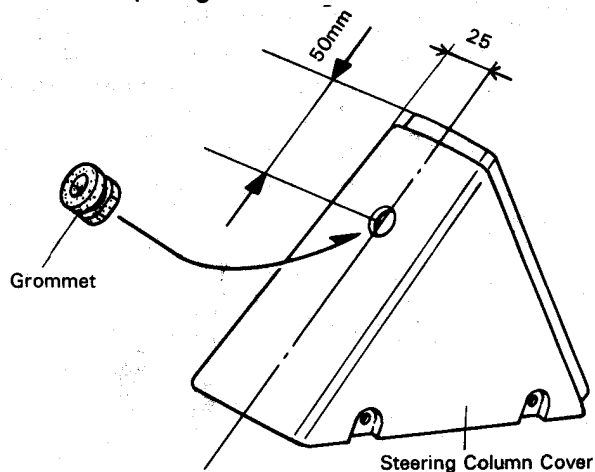

6. Disconnect the Green, 6-pin connector located under the steering column cover. Connect the Power harness in series with the two green connectors of the main wire harness.

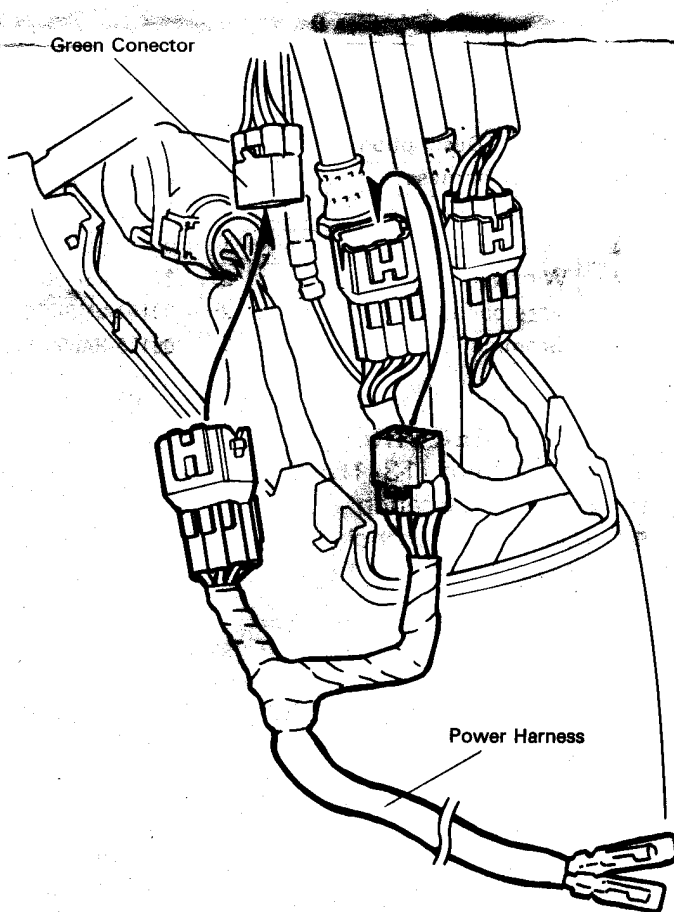

7. Route the Power harness through the hole in the steering cover. Slip the grommet over the harness and press it into the hole in the cover. Pull the harness through, leaving some slack between the cover and the connectors.
8. Install the steering column cover.
9. Locate the ignition coil and slide it off its mount. Disconnect the black/yellow coil wire.
10. Connect the Pulser harness in series with the coil and the black/yellow wire.

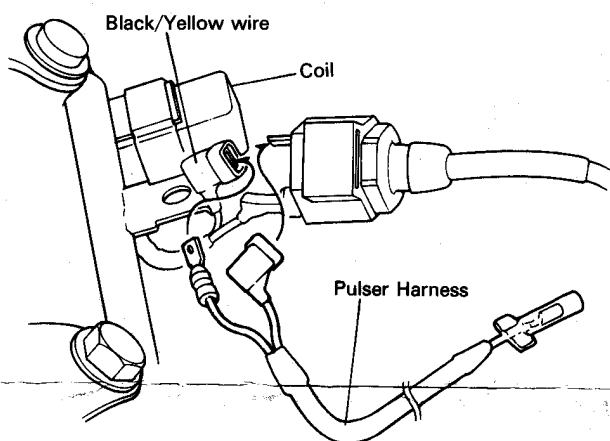

11. Run the Pulser harness forward, along the frame, to the tachometer as shown in the illustration. Attach the Pulser harness to the frame using the wire bands at the locations shown in the illustration.

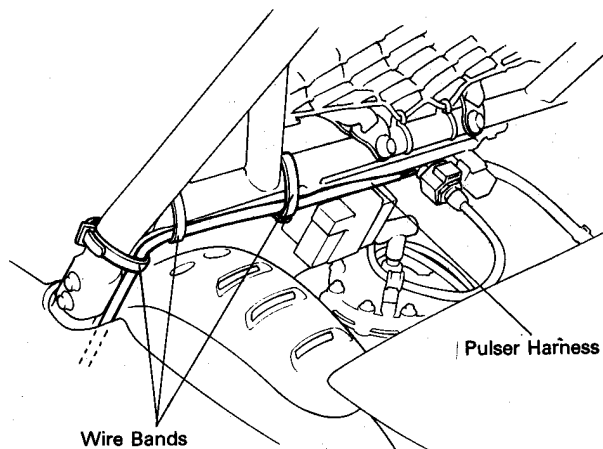

12. Locate the three wire connectors, inside the left front fender above the shock adsorber. Open the wire clamp and push back the plastic cover. Disconnect the green wire connectors. Connect the ground harness in series with the green wires and pull the plastic cover over the connectors. Clamp the covered connectors in place.

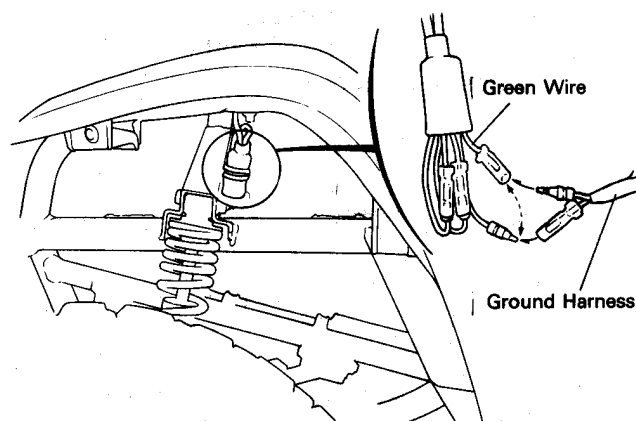

13. Route the harness under the fender and up to the tachometer.

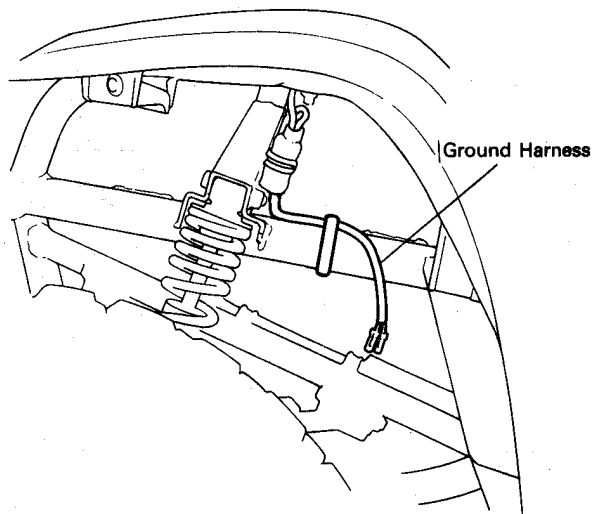

14. Connect the three tachometer wires as follows:

- The black wire to the power harness connector with the black/brown wire.
- The green wire to one of the ground harness connectors.
- The black/yellow wire to the Pulser harness connectors.

15. Connect the two tachometer light wires as follows:

- The brown wire to the power harness connector with the brown wire harness connector.
- The green wire to the other ground harness connector.

16. Position the tachometer, so it may be easily seen by the rider. Torque the two 6×16mm bracket flange bolts.

Torque : 1.2 kg-m, 12 N.m (9 lb-ft).

17. Carefully bundle any excess wiring and pack it under the cross bar pad. Secure the pad and the wires with the two long wire bands.

